

Assembly instructions for VarioShield^{BASIC} lead lined plaster panels

These instructions show how you can construct a radiation-proof room with the VarioShield^{BASIC} panels following a number of simple steps. The panels can be mounted using a metal stud system.

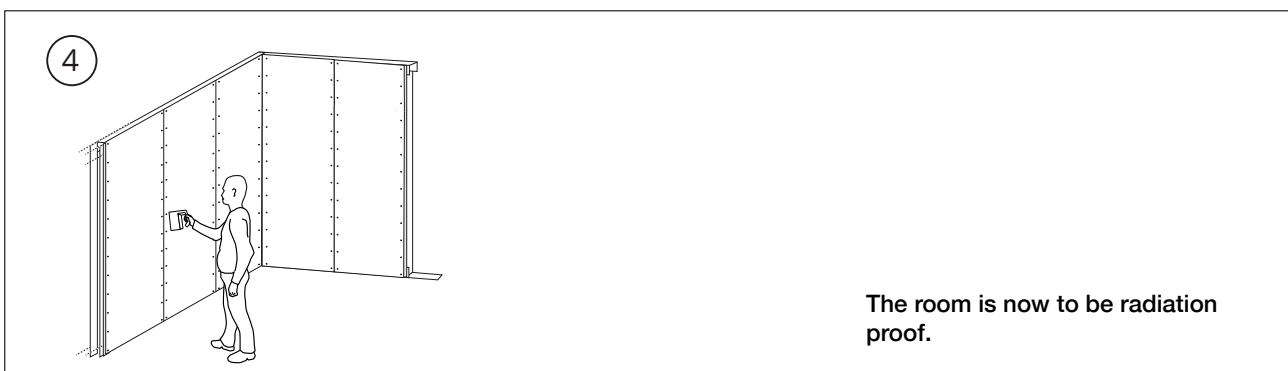
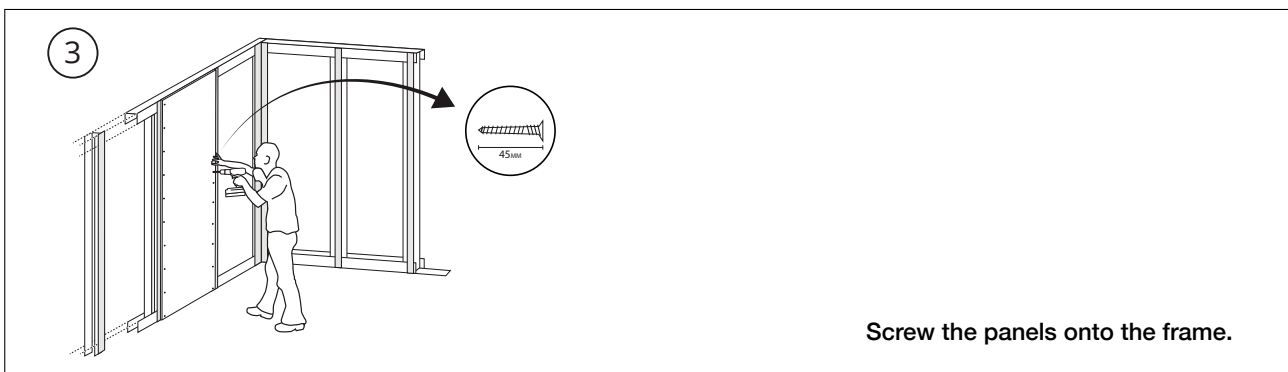
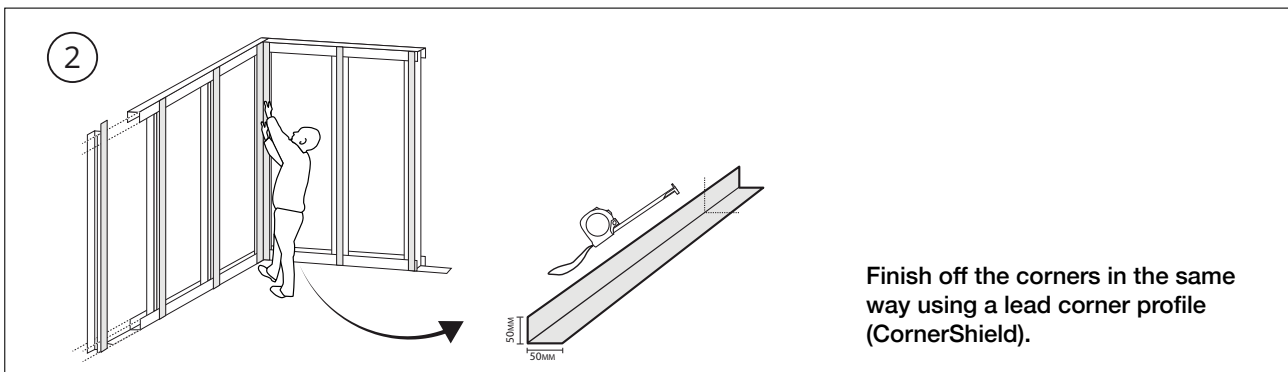
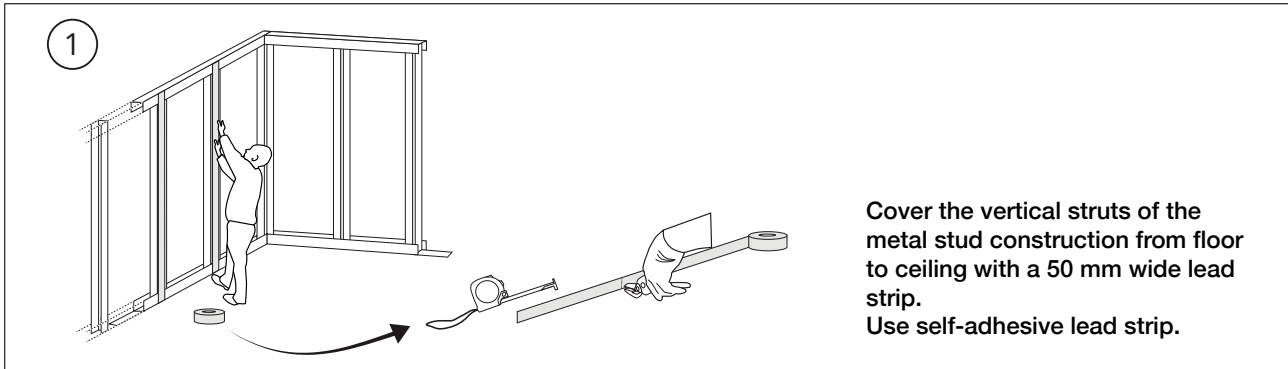

The advantages of VarioShield^{Basic} panels

- panels cut to size
- return scheme for old lead
- system tested and approved by Applus RTD

Product description

Variable VarioShield^{Basic} lead lined plaster panels: 12.5 x 600 x 2000 mm up to 2600 mm.

Lead thicknesses: 0.5 mm - 1.0 mm – 1.5 mm – 2.0 mm – 2.5 mm – 3.0 mm

Applications: As radiation-proof wall or ceiling panel for the necessary protection of rooms where work is carried out using sources of radiation, such as in dentist and GP surgeries, hospitals, customs scanning units and laboratories.

Transport and storage

VarioShield^{Basic} panels are supplied on returnable pallets. They should be stored in a dry space on a level and stable surface.

Assembly

Use VarioShield screws, sealing tape and filler as you would use when assembling standard plasterboard. The thickness of the lead strip must correspond with the thickness of the lead on the panel used.

VarioShield^{Basic} lead lined plaster panels have been tested and approved by Applus RTD in standard setups.



VarioShield BV
Korenmaat 12c
9405 TJ Assen, The Netherlands

T (+) 31 592 33 01 23
E info@varioshield.com
W www.varioshield.com

